



# CAMPUSES AND CENTERS

## CAMPUSES AND CENTERS

DISTRICT OFFICE  
Pensacola Campus  
1000 College Boulevard  
Pensacola, Florida 32504-8998  
(850) 484-1000(888) 897-3605  
[www.pensacolastate.edu](http://www.pensacolastate.edu)

Milton Campus  
5988 Highway 90  
Milton, Florida 32583-1798  
(850) 484-4400

Warrington Campus  
5555 West Highway 98  
Pensacola, Florida  
32507-1097  
(850) 484-2200

Downtown Center  
418 West Garden Street  
Pensacola, Florida 32502-4731  
(850) 484-1374

Century Center  
440 East Hecker Road  
Century, Florida 32535-2819  
(850) 471-4622

South Santa Rosa Center  
5075 Gulf Breeze Parkway  
Gulf Breeze, Florida  
32563-9334  
(850) 471-4630

Truck Driver Training Facility  
5957 Jeff Ates Road  
Milton, FL 32583  
(850) 484-1795

# CAMPUS MAPS

## Pensacola Campus

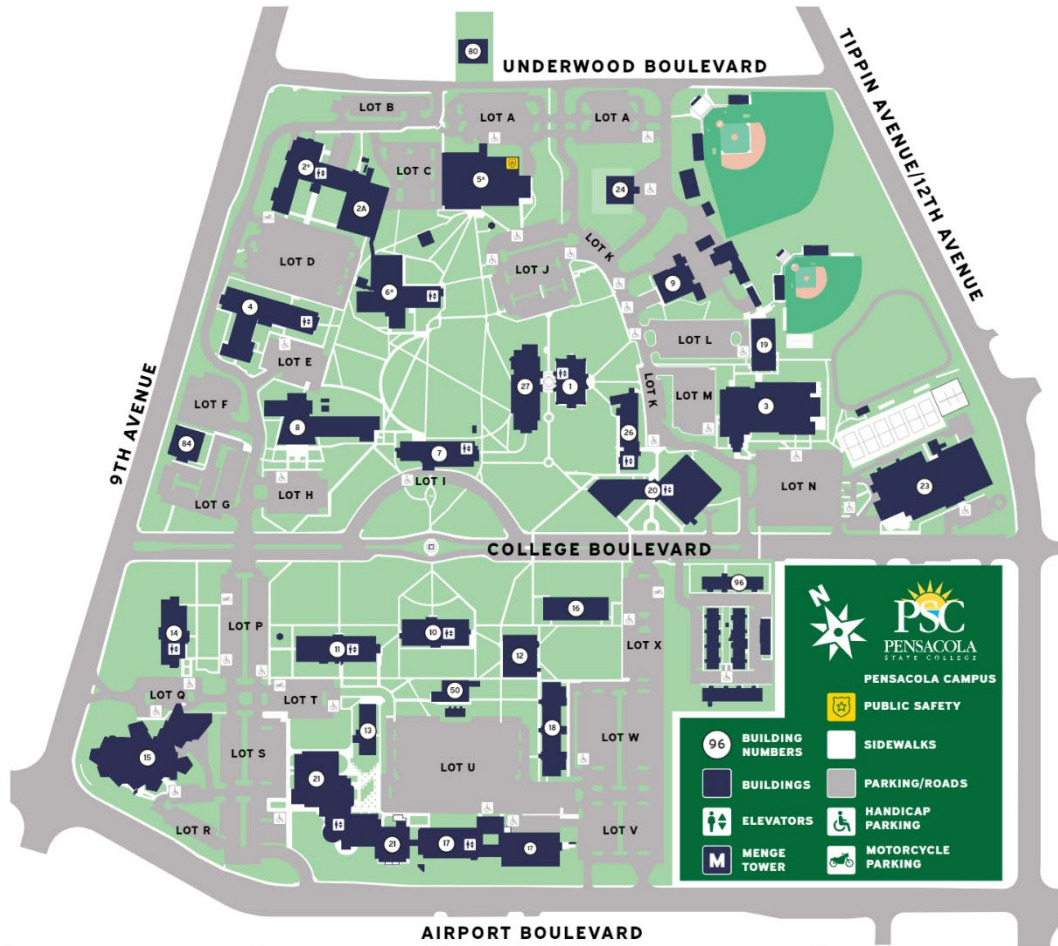

- |   |  |  |   |
|---|--|--|---|
| <p><b>1 BAARS TECHNOLOGY BUILDING</b></p> <p><b>2 REGISTRATION CENTER</b><br/>Admissions and Information Center<br/>Student Financial Services<br/>Financial Aid / Scholarships<br/>Registration</p> <p><b>2A HAGLER AUDITORIUM</b></p> <p><b>3 LOU ROSS CENTER</b><br/>Athletic Director Coaches' Offices<br/>Hartsell Arena Swimming Pool</p> <p><b>4 ALLEN LIBERAL ARTS BUILDING</b><br/>English and Communications<br/>Department</p> <p><b>5 DELAINO STUDENT CENTER</b><br/>Bookstore<br/>Culinary Arts Dining Room<br/>Public Safety - Student ID Center<br/>Student Leadership and Activities<br/>Subway Food Service<br/>Institutional Equity and Student<br/>Conduct<br/>Esports Game Room</p> | <p><b>6 STUDENT AFFAIRS</b><br/>Vice President Administrative Services<br/>and General Counsel<br/>Career and Technical Education<br/>Educational Opportunity Center<br/>Educational Talent Search<br/>Student Support Services<br/>Student Resource Center &amp; ADA Services<br/>Student Job Services<br/>Student Veterans' Lounge<br/>Testing Center<br/>Veterans Affairs Center<br/>Veterans Upward Bound</p> <p><b>7 BARFIELD ADMINISTRATION BUILDING</b><br/>Office of the President<br/>Vice President Academic Affairs<br/>Vice President Business Affairs<br/>Comptroller<br/>Institutional Research<br/>Staff and Professional Development<br/>Dean, Institutional Effectiveness<br/>and Grants<br/>Human Resources Department<br/>Marketing and College Information<br/>Purchasing</p> <p><b>8 ASHMORE FINE ARTS CENTER</b><br/>Auditorium<br/>Performing Arts Department</p> <p><b>9 PHYSICAL PLANT</b><br/>Mail Room<br/>Receiving<br/>Facilities Planning and Construction<br/>Maintenance<br/>Transportation Services</p> | <p><b>10 BUSINESS BUILDING</b><br/>Business Department</p> <p><b>11 HOBBS CENTER FOR TEACHING EXCELLENCE</b></p> <p><b>12 COSMETIC ARTS</b></p> <p><b>13 INFORMATION TECHNOLOGY SERVICES</b></p> <p><b>14 SPEARS BEHAVIORAL SCIENCES BUILDING</b><br/>History, Language, and Social<br/>Sciences Department</p> <p><b>15 SWITZER CENTER FOR VISUAL ARTS</b><br/>Visual Arts Department Gallery<br/>Charles W. Lamar Studio</p> <p><b>16 MANAGEMENT INFORMATION SYSTEMS</b></p> <p><b>17 BAROCO CENTER FOR SCIENCE &amp; TECHNOLOGY (EAST)</b><br/>Applied Technology Department<br/>Biological Sciences Department<br/>Physical Sciences Department<br/>Cisco Training Center<br/>Pensacola State College Foundation</p> <p><b>18 MECHANICAL TECHNOLOGY LAB</b></p> <p><b>19 GYMNASIUM</b></p> | <p><b>20 CHADBOURNE LIBRARY</b><br/>Coffee Shop<br/>e-Learning<br/>Dean, Baccalaureate Studies and<br/>Academic Support</p> <p><b>21 BAROCO CENTER FOR SCIENCE &amp; TECHNOLOGY (WEST)</b><br/>Academic Computing Center<br/>Planetarium</p> <p><b>23 KUGELMEN CENTER FOR TELECOMMUNICATIONS</b><br/>Jean &amp; Paul Amos Performance Studio<br/>WSRE-TV</p> <p><b>26 1ST FLOOR: L.I.F.E. CENTER</b></p> <p><b>27 BEAR, JONES, MOORE, REEVES CENTER FOR MATH AND ADVANCED TECHNOLOGY</b><br/>Mathematics and Computer Science<br/>Department<br/>Grand Hall<br/>Morette Sky Terrace</p> <p><b>50 MECHANICAL SOUTH UTILITIES</b></p> <p><b>80 WELDING LAB</b></p> <p><b>84 WEIGHT TRAINING FACILITY</b></p> <p><b>96 COLLEGE CENTER</b><br/>Continuing Education<br/>Workforce Education<br/>Corporate and Professional Training</p> |
|---|--|--|---|

\* Garrett T. Wiggins Student Complex consists of Buildings 2, 5, and 6.

Milton Campus

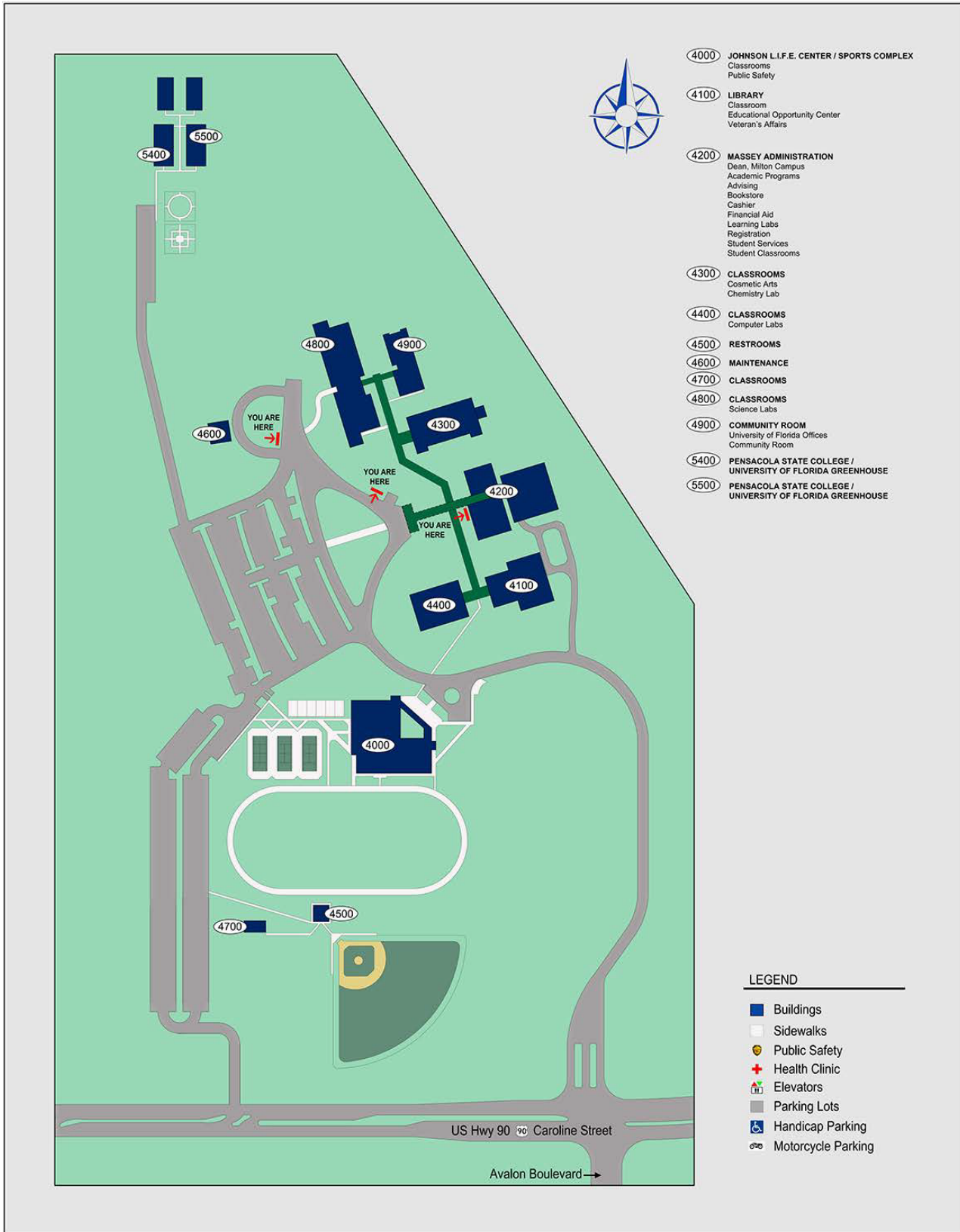

**Warrington Campus**

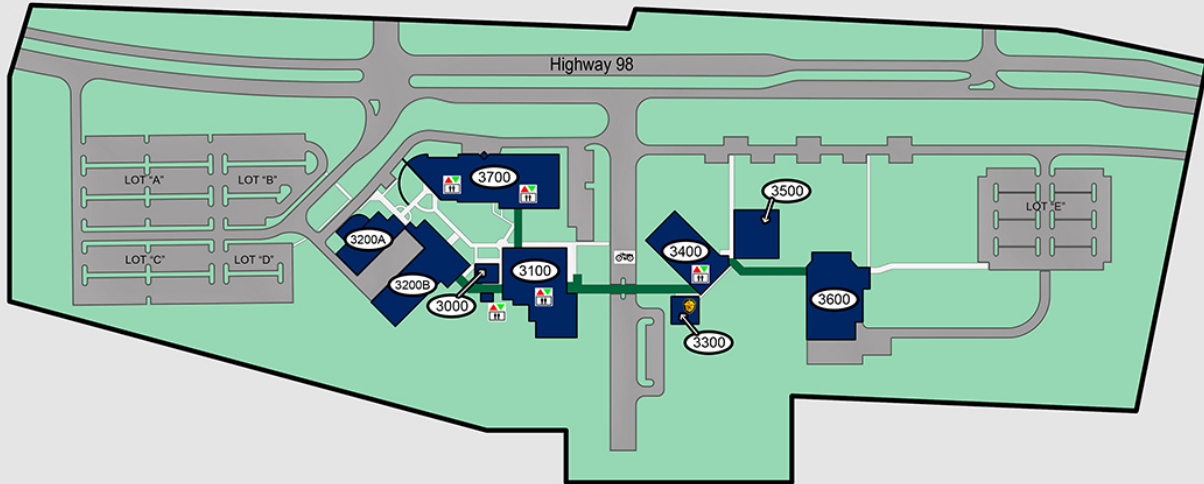

- 3000** AUDITORIUM
- 3100** BOYD HEALTH RELATED EDUCATION BUILDING  
Allied Health Department  
Nursing Department  
Dental Clinic  
Computer Center  
Sonography  
Medical Assisting  
Medical Office Programs
- 3200A** VET TECH  
Veterinary Technician  
Classrooms
- 3200B** FITNESS CENTER  
Fitness Center  
Physical Therapist Assistant  
Radiography
- 3300** PUBLIC SAFETY  
Public Safety  
Student ID / Parking Decals  
Testing

- 3400** VENETTOZZI ARTS & SCIENCES BUILDING  
Adult Education  
Classrooms  
Science Labs
- 3500** LIBRARY
- 3600** HARRISON STUDENT AFFAIRS BUILDINGS  
Advising  
Bookstore  
Cashier  
Educational Opportunity Center  
Financial Aid  
Food Service  
Registration  
Student Services  
Veterans Affairs
- 3700** ATWELL HEALTH SCIENCES COMPLEX  
Dean, Warrington Campus  
Smart Center for Patient Simulation Training  
and Research  
D.W. McMillan Auditorium



**LEGEND**

- Buildings
- Sidewalks
- Public Safety
- Elevators
- Parking Lots
- Handicap Parking
- Motorcycle Parking

**Century Center**

---

**CENTURY CAMPUS**

440 E. HECKER RD  
CENTURY, FLORIDA 32535  
(850) 471-4622

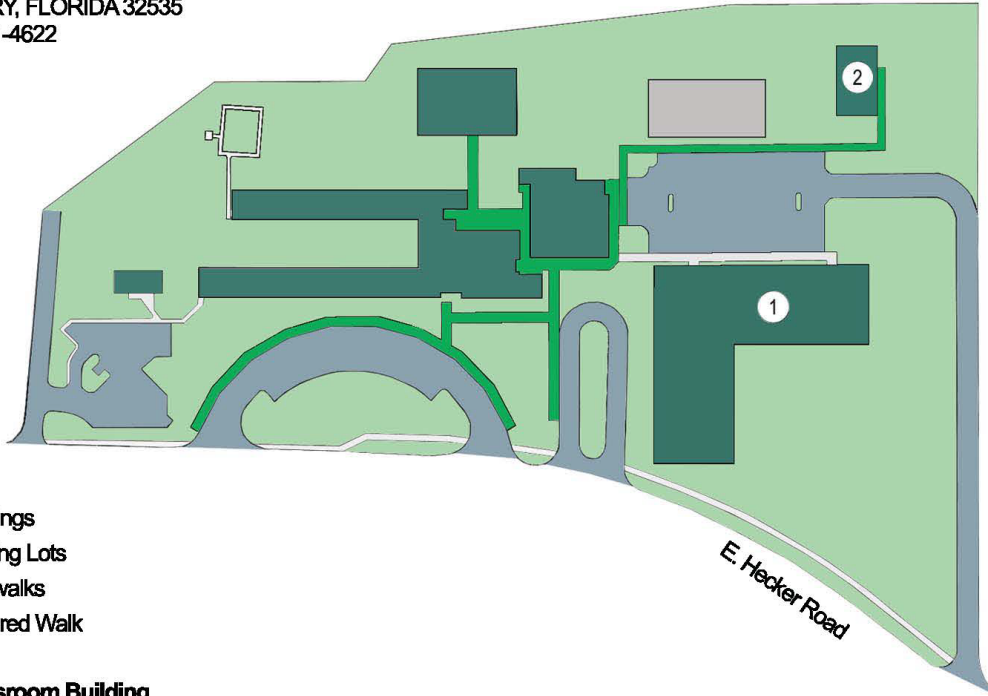

-  Buildings
-  Parking Lots
-  Sidewalks
-  Covered Walk

**1 Classroom Building**  
Administration  
Classrooms

**2 Storage Building**

**South Santa Rosa Center**

---

**SOUTH SANTA ROSA CENTER CAMPUS**

5075 GULF BREEZE PKWY  
GULF BREEZE, FLORIDA 32563  
(850) 471-4630

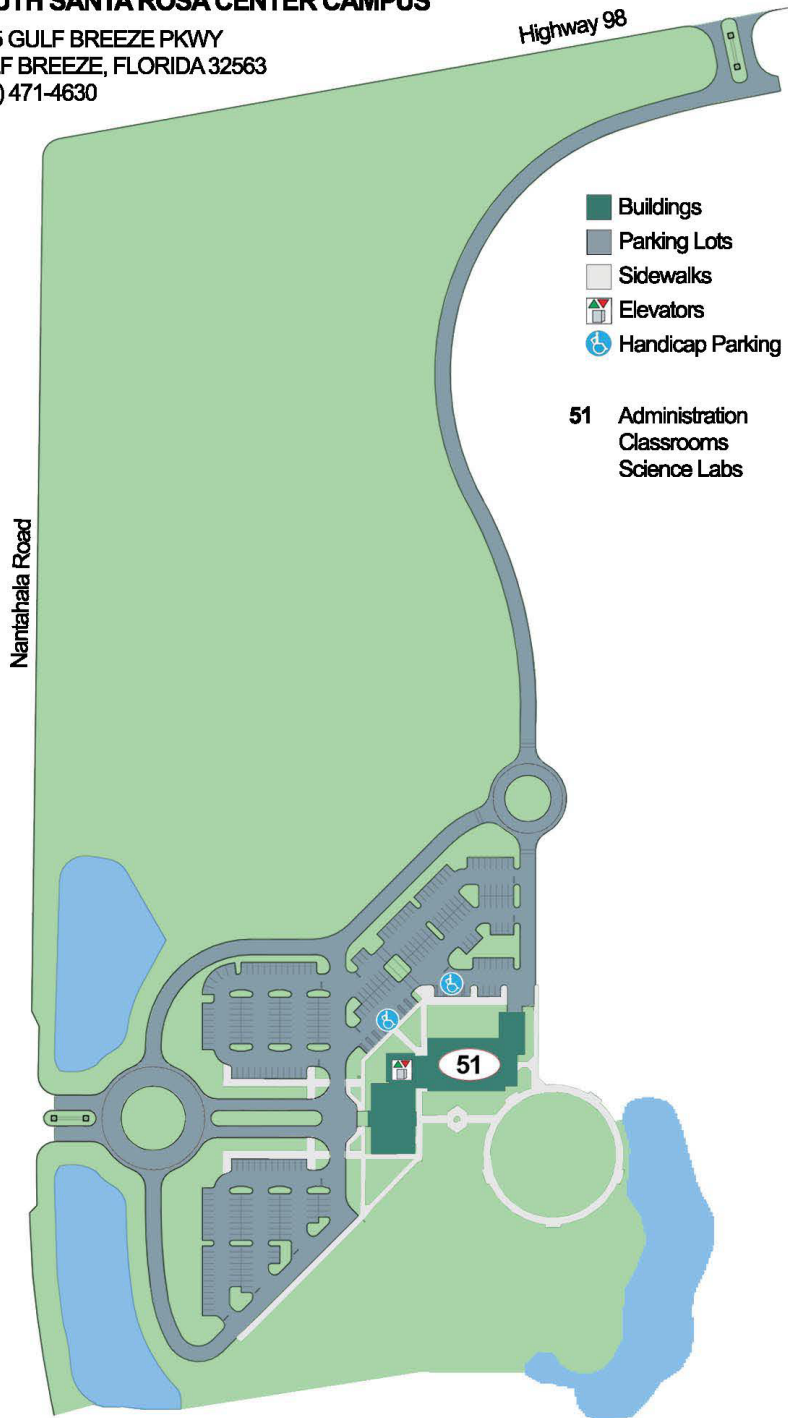

-  Buildings
  -  Parking Lots
  -  Sidewalks
  -  Elevators
  -  Handicap Parking
- 51** Administration  
Classrooms  
Science Labs